

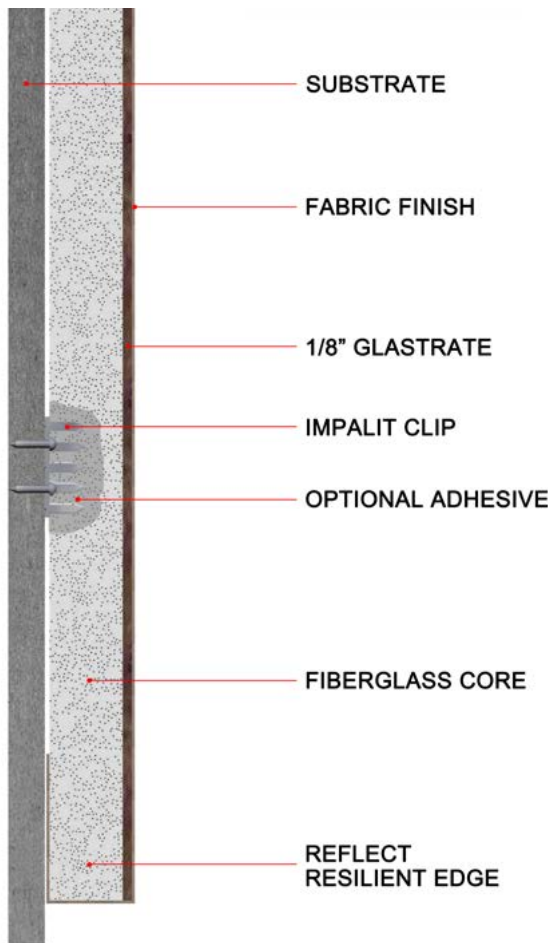

soundconcepts

HIR 1 - High

Impact Resistant Acoustical Wall Panels



HIR 1- High Panels Provide

- Suitable for use in corporate and educational areas that receive normal abuse, need tackable surfaces or will be finished with a light weight low texture fabric
- Extensive finish options available in EUROMA, polyesters, olefins, polyolefins, polypropylenes and Xorel fabrics plus vinyls and COM fabrics plus vinyls, and COM

LEED Credits

- MR Credit 4.1 = 1 point
- MR Credit 4.2 = 1 point
- EA Credit 1 = 1 to 10 points
- EQPR3 Prerequisite
- EQ Credit 7.1 = 1 point
- EQ Credit 9 = 1 to 2 points
- EQ Credit 10 = 1 point

Reflect

Reflect resilient or hardened edges in square, bevel, chamfer, pencil radius, bullnose + custom configurations

Sustainable Fiberglass Core

- 50% post-consumer recycled glass
- Manufactured in Shelbyville, IN



soundconcepts

P 204.783.6297

TF 866-525-4496

E estimating@soundconceptscan.com

W soundconceptscan.com

A 599 Henry Avenue,
Winnipeg, MB, Canada R3A 0V1



Specifications

Section 09 83 19
Acoustical Wall Panels

Materials

6 pcf fiberglass cores with a 1/8" high density GLAstrate surface are inert, non-combustible, dimensionally stable and fully upholstered with heat sealed corners

Configurations

Flat, curved, flexible

Fire

ASTM E 84 all components are Class A

Corner

Square, radius + custom

Shape

Rectangular + custom

Size

Up to 48" x 120" + custom

Edge

Profile: square, bevel, chamfer, pencil radius, bullnose + custom

Construction: REFLECT resilient standard with optional hardened and aluminum edges

Acoustics

Description	hz	125	250	500	1000	2000	4000	NRC
1-1/8"		0.09	0.50	0.99	1.13	1.08	1.96	0.95
1-5/8"		0.23	0.64	1.16	1.16	1.14	1.02	1.05
2-1/8"		0.32	0.91	1.09	1.14	1.02	1.98	1.05

Tested per ASTM C-423 in a type A mounting with unbacked, acoustically transparent panel fabric

Mounting

IMPALIT CLIP, ROTOFAST, z-bar/z-clip, z-clip/z-clip, adhesive, magnetic



White

Standard EUROMAT Colors



Lakeshore Reflection



Silver Pea



Midnight Cove



Forever Peach



Fallen Acorn



Spring Dew



French Vanilla



Shell



Pale Lemon



Pecan



Sky



Moss



Stone



Reef



Lagoon



Plum



Cranberry



Kiwi



Tangerine



Black

Option: color matching to all major paint manufacturers, most breathable fabrics, vinyl and complete custom fabric capabilities

Limitation

HIR-1 HIGH IMPACT RESISTANT panels are not intended for use in harsh environments such as exteriors, kitchens, food processing, food preparation and cleanrooms EUROMAT are not designed for use in the occupied space and should be restricted to wall applications above 10'. The use of acrylic backed fabrics will reduce the acoustical performance of the panel

