

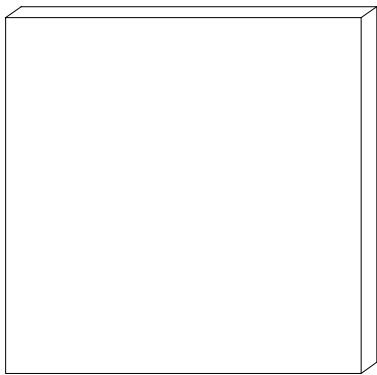

**sound**concepts

# Absorbers & Diffusers

## Interact Acoustical Absorbers



**TYPICAL ABSORBER**

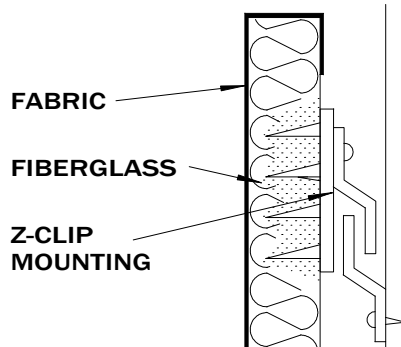

**TYPICAL INSTALLATION**

### Interact Absorbers Provides

Sound Concepts Interact Acoustical Absorbers are manufactured from our standard 6 - 7 pcf fiberglass core which is acoustically absorptive. The entire core is inert, non-combustible and dimensionally stable.

The most common application of these panels are when the panels are wrapped with a 100% woven polyester fabric. The fabric is bonded with acoustically transparent adhesive to the face, edges and back to a minimum of 1-1/2" to eliminate fabric sag or puckering. All corners are tailored and heat fused.

Typical absorber other facing materials ranging from webcore vinyls to designtex fabrics, maharam fabrics to arc-com fabrics are also available.

Consult your local rep or factory consultant for availability and suitability. Added benefits of our absorber panels includes tackability and the ease to perform field modifications and cutouts. Through a combination of absorbers and diffusers this provides a proper acoustical environment. This allows both performers and audience members to better hear and enjoy the performance.



**sound**concepts

**P** 204.783.6297

**TF** 866-525-4496

**E** [estimating@soundconceptscan.com](mailto:estimating@soundconceptscan.com)

**W** [soundconceptscan.com](http://soundconceptscan.com)

**A** 599 Henry Avenue,  
Winnipeg, MB, Canada R3A 0V1



**sound**concepts

# Product Data

## Interact Acoustical Absorbers

### Mounting

IMPALIT CLIPS (2" ONLY), Z-CLIP / Z-BAR (2", 3" OR 4")  
Leveling Brackets Required On 3" & 4" Panels.

### Facing Materials

100% Woven polyester and most other panel fabrics  
(contact your local rep or factory consultant for  
availability & suitability)

### Size

STANDARD - UP TO 48" x 120"  
(Custom Sizes Also Available)

### Standard Tolerances

(+) (-) 1/16" On Length, Width & Thickness

Description	hz	125	250	500	1000	2000	4000	NRC
2" Fiberglass With Fabric		0.33	0.71	1.23	1.29	1.22	1.24	1.10
3" Fiberglass With Fabric		0.58	1.16	1.16	1.25	1.18	1.12	1.20
4" Fiberglass With Fabric		0.76	1.16	1.24	1.33	1.23	1.16	1.25

ALL NOISE REDUCTION COEFFICIENT (NRC) TESTS AS PER ASTM C-423 (TYPE A MOUNTING)

ALL REFLECT PANEL COMPONENTS MEET CLASS A FLAME SPREAD AS TESTED UNDER ASTM E-84 CONTACT SOUND  
CONCEPTS FOR SOUND ABSORPTION AVERAGE (SAA) VALUES



**sound**concepts

**P** 204.783.6297

**TF** 866-525-4496

**E** [estimating@soundconceptscan.com](mailto:estimating@soundconceptscan.com)

**W** [soundconceptscan.com](http://soundconceptscan.com)

**A** 599 Henry Avenue,  
Winnipeg, MB, Canada R3A 0V1